

Content

Silver Peel

01.Important Safeguards	3
02.Silver Peel Unit	4
03.Connecting the « Crystal Free » System and filter replacement	5
04.Contraindications of « Crystal Free » Exfoliation	7
05.Metallic Tips Cleaning and Sterilisation	8
06.Protocol of « Crystal Free » Procedure	9
6.1 Procedure Parameters: Metallic Tips	9
6.2 Procedure Schedule: Metallic Tips	9
6.3 Exfoliation Protocol: Metallic Tips	10
6.4 Exfoliation Protocol: Diamond Tips & Metallic Tips	10
6.5 Procedure Chart	15
6.6 Potential Side Effects	16
07.Consent Form	17
08.Client's Instructions Sheet	18
09.Important	19
10.Warranty	19
11.Specifications	20

SILVER



P e e l

Crystal Free Microdermabrasion

Thank you for purchasing the Silver Peel exfoliation system. We realize that there are many Crystal free systems available and we are confident that choosing a Silhouet-Tone product, crafted and manufactured in North America, will reward you with many years of trouble free operation and the excellent results the industry has come to expect from Silhouet-Tone products.

All rights reserved. No part of this work covered by the copyright hereon may be reproduced or used in any form or by any means— graphic, electronic, or mechanical, including photocopying, recording, taping, or information storage and retrieval systems— without permission of the company.
© Silhouet-Tone Corporation 2016

01. Important Safeguards

Read the following instructions before using this unit.

1. This device is intended to be used only for purposes that are approved and described in this original manual. Use only with instructions recommended by the manufacturer.
2. Never perform a procedure on inappropriate or sensitive areas.
3. Prior to each use of the system, inspect all cables and attachments for any damage, excessive wear, or crimping that could affect system performance or safe operation. Never use the system if any damage is visible.
4. Do not use this device if the power cord has been damaged, if it is not working / operating correctly or damaged. If the supply cord is damaged, it must be replaced by a special cord or assembly available from the manufacturer or its service agent.
5. Keep power cord away from heat source.
6. **WARNING:** To avoid the risk of electric shock, this equipment must only be connected to a supply main with protective earth.
7. **WARNING:** Caution should be exercised to avoid spilling any liquids on the unit.
8. Never pull the power cord to disconnect the equipment from the mains. Always do so by firmly grasping and pulling the connector. Always allow enough space between the equipment and the mains for easy disconnect or plug in access.
9. This device should only be operated by an appropriately trained and certified personnel possessing knowledge of the skin physiology and only in a professional setting. If you have any questions regarding the operation of this unit, contact Silhouet-Tone or your local distributor. This appliance is designed to be used only by trained professionals in commercial areas.

10. Grounding instructions:

This unit must be properly grounded. In the event of a short-circuit, the power cord's ground prong will reduce the risk of electric shock by providing an escape route for the current.

The power cord is equipped with a grounding wire and three-pronged plug. The power cord must be plugged into a properly installed three-pronged grounded outlet.

DANGER: THE IMPROPER USE OF A GROUNDING PLUG MAY CAUSE ELECTRIC SHOCK.

WARNING: DISCONNECT THE APPLIANCE FROM ITS POWER SOURCE DURING SERVICE AND WHEN REPLACING PARTS.

11. The power cord should be routed so that they are less likely to be walked on or pinched by items placed on or against them. Pay particular attention to cords at plugs, convenience receptacles, and the point where they exit the unit.
12. Do not use any adaptors with this unit. Do not modify the plug if it does not fit the outlet. Have an electrician install a suitable outlet.
13. Do not overload wall outlets and extension cord; this can lead to an increase risk of fire or electric shock.
14. All maintenance work must be done by SILHOUET-TONE or an authorized service representative. Do not attempt to service this unit yourself. Opening the unit may expose you to high voltage or other hazards, and will void your warranty. Always use Silhouet-Tone certified replacement parts and accessories.
15. To insure continuous protection against fire, always replace the fuse with one of identical type and amperage, as approved by the manufacturer.
16. Never immerse the hand piece in any type of solution.
17. Slots and openings in the unit casing are for ventilation. They are there to ensure reliable operation and prevent overheating. These openings must not be blocked or covered. This unit should not be placed in a built-in installation unless proper ventilation is provided for.
18. Do not use other accessories than those recommended by the manufacturer. Improper accessories can damage the unit's components and create blockages.
19. Do not use the unit near water—for example: near a sink, wash bowl, hydro tub, steamer, wet table, swimming pool, autoclave, hot cabi.
20. Do not place the unit on an unstable cart, stand, tripod, bracket, or table. A fall could produce serious injury and serious damage to the unit. Use only with recommended base. Follow manufacturer's instructions for unit installation onto base. The combination should be moved carefully. Quick stops, excessive force, and uneven surfaces may cause damages to the unit.
21. This appliance is not intended for use by persons (including children) with reduced physical, sensory or mental capabilities, or lack of experience and knowledge, unless they have been given supervision or instruction concerning use of the appliance by a person responsible for their safety.

Children should be supervised to ensure that they do not play with the appliance.

Save these instructions!

02. Silver Peel Unit

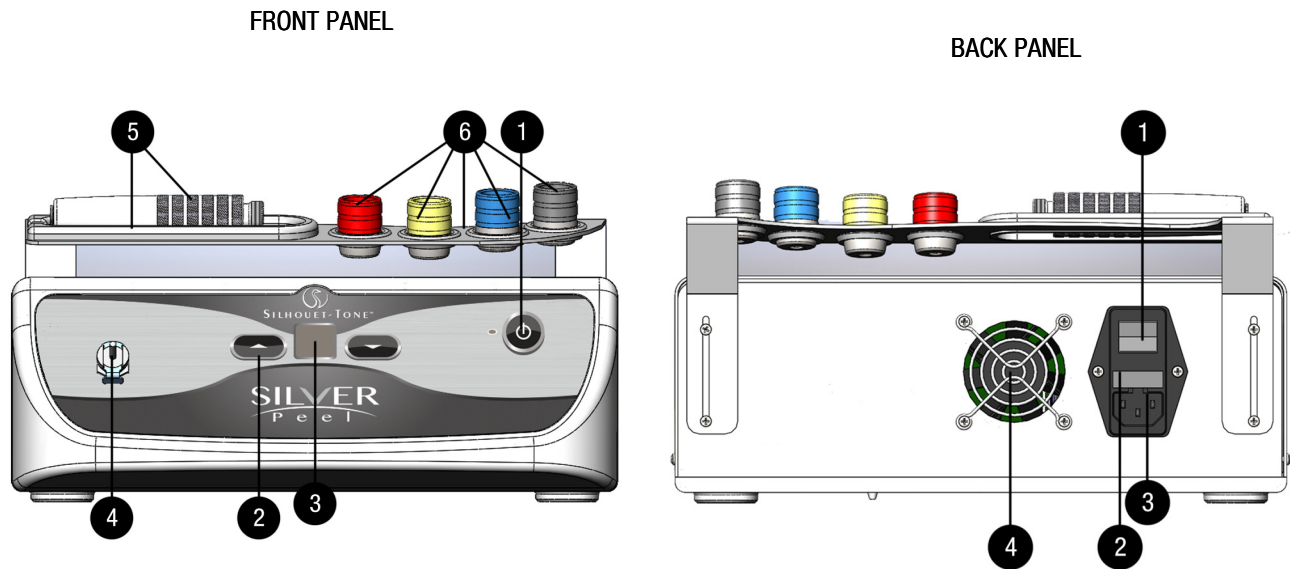

1. Procedure START / STOP key.
2. Intensity control (UP / DOWN).
3. Intensity display screen (00-10).
4. Hand piece connection outlet.
5. Hand piece cradle.
6. "Crystal Free" tip cradles.

1. ON / OFF main switch.
2. Fuse box.
3. Power cord outlet
4. Ventilation opening.

Starting the procedure :

- Connect the "Crystal Free" System to Silver Peel unit (*as per instructions below*).
- Turn on the main power switch on the back of the unit. (*The LED indicator on front panel will light up*).
- Wait at least 10 seconds for unit to warm up.
- Press the "START / STOP" key (*on the front panel*).
- Adjust the abrasion / vacuum power with the intensity key (*located on the front panel*).
- The intensity will appear on your screen.

⚠ Note: Ensure the central unit is **POWERED OFF** before connecting crystal free hand piece.

⚠ WARNING:

- ✓ *Always begin procedure at the lowest intensity setting.*
- ✓ *Always insure that the filter is inserted into the hand piece before any procedure.*

03. Connecting the “Crystal Free” System

Crystal free hand piece

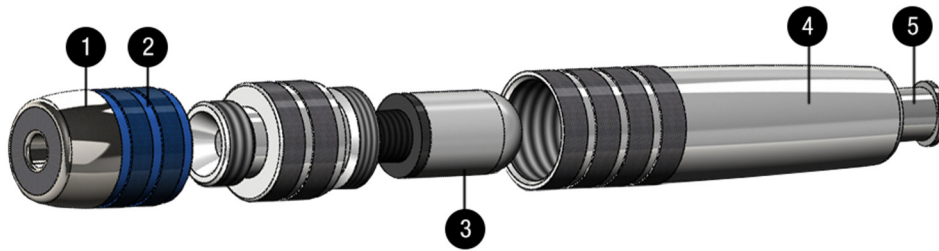

1. Crystal free stainless steel tip.
2. Color coded band, identifying abrasiveness index.
3. Crystal free internal filter.
4. Crystal free handle.
5. Hand piece tube's outlet.

Color coded tips indicating degree of abrasiveness



Connecting the “Crystal Free” hand piece

- Connect one end of the vacuum tube into the vacuum outlet of your Silver Peel unit (*outlet #4 on front panel*) and the other end into the crystal free hand piece tube's outlet (*outlet #5 on above picture*).
- Choose the appropriate tip (according to desired degree of abrasion) and screw into place.
- Turn the unit on.

⚠ Note: Ensure the Silver Peel unit is **POWERED OFF** before connecting crystal free hand piece.

⚠ WARNING:

- ✓ Always begin procedure at the lowest intensity setting.
- ✓ Always insure that the filter is inserted into the hand piece before any procedure.

Changing Metallic Tips internal filter (#3)

The filter located inside the hand piece constantly collects skin residue and periodically (every 10-12 sessions) requires verification.

Procedure:

- When the filter needs to be replaced, “CF” inscription will appear on your Silver Peel’s display screen (# 3 on the front panel).
- Unscrew the crystal free handle than unscrew the filter.
- Discard the old filter.
- Screw the new filter in place, than the crystal free handle.
- Press concomitantly on both intensity control arrows (# 2 on the front panel) to reset the “CF” inscription.
- You can restart a new series of about 10-12 sessions.



IMPORTANT:

- ✓ *It is strongly recommended to replace the Metallic Tips internal filter when Silver Peel unit indicates “CF” inscription. If filter is not replaced the vacuum intensity will drop progressively and can damage the unit.*
- ✓ *A drop in suction intensity requires IMMEDIATE replacement of the hand piece’s internal filter.*
- ✓ *New filters can be ordered from Silhouet-Tone or your local distributor.*
- ✓ *We recommend having few filters on hands to replace as needed.*

Diamond Tip System set-up

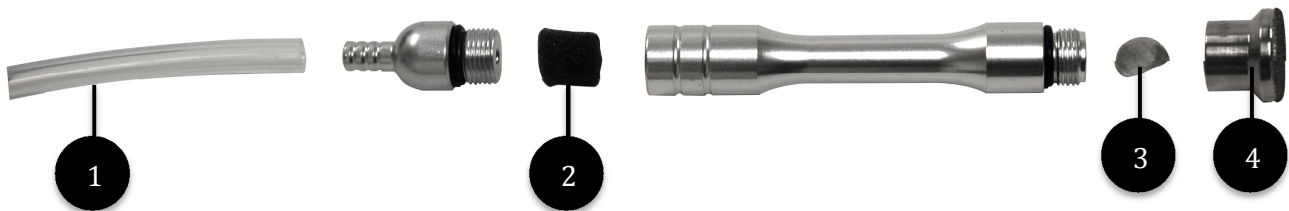

1. Insert the Diamond tip wand into the vacuum tube (#1) and connect tube to the unit.
2. Select the Diamond tip (#4), install filters (#2 and #3) and screw onto the wand.

Changing Diamond Tips filters

2 Filters are used, they provide 2 levels of protection. If the small flat filter is compromised, the larger black foam filter, will catch dirt and skin debris.



IMPORTANT: If the filters are not regularly replaced, dead skin cells may enter into the system causing it to lose suction power.

✓ **When to replace filters:**

1. The small mesh filter should be replaced after each use.
2. The larger cylinder foam filter should be replaced after 6 abrasions. The foam filter will catch dead cells to prevent clogging of your machine

Where to insert filters:

- a. The flat mesh filter fits into the abrasive tips.
- b. The black cylinder foam filter is inserted into the base of the wand.

04. Contraindications of Crystal Free Exfoliation

Reminder

- Refer client to physician for any medical treatments or doubts regarding skin conditions.
- Perform Crystal Free procedure ONLY on healthy skin, free of infections or inflammations (wounds, infected scars, acne, etc.).
- Do not abrade beauty spots or moles, by-pass them without touching.

CONTRAINDICATIONS

- Allergy to stainless steel.
- Active local skin infection of all types (herpes simplex virus, flat warts, etc.).
- Active acne (with pustules).
- Users of Isotretinoin medication (Accutane, Roaccutane) must wait 6 months between medication interruption and beginning of exfoliation procedure.
- Vascular lesions (broken capillaries and rosacea).
- Uncontrolled diabetes.
- Eczema, dermatitis or any inflammatory skin condition.
- Skin Cancer.
- Blood thinner.
- Any medical condition that prohibits exfoliation.



WARNING:

- ✓ ***BEFORE A PROCEDURE, INSPECT THE TIP for any excessively jagged or abnormally formed surfaces on the tip (anything that could cause a cut in the skin). DO NOT USE THE TIP if you notice any damage.***
- ✓ ***Prior to procedure, always test the abrasion intensity on the inside of the client's forearm, where the skin is most sensitive. Wait for 5 minutes and if no reaction is observed (redness, rash, bumps, swelling or any other reaction on tested area) you can begin procedure. If any reaction appears, do not proceed, if necessary refer the client to a doctor.***
- ✓ ***Extra care must be taken when working on mature or reactive skin.***
- ✓ ***For first exfoliation, always use the fine metallic tip at the lowest suction.***

Potential Side Effects

Metallic tips are made of biocompatible material therefore skin allergic reactions are rare. The majority of reactions (unless allergy to stainless steel presented) are related to procedure's intensity and user's manipulations.

Potential side effects:

- Mild erythema and increased sensitivity may be observed, but usually resolves within 24 hours.
- Petechial spots (small red-purple spots on the skin) may appear during or after the procedure. This indicates that settings are too strong so you need to reduce the intensity. Mature skin is particularly susceptible to this type of reaction but will usually resolve within 48 hours.
- Telangiectasia or other vascular conditions may be aggravated by crystal free skin exfoliation.
- Mild flaking may occur over 2 days.
- Post microdermabrasion hyperpigmentation effect can be avoided by avoiding sun exposure and using sun block.

05. Metallic Tips Cleaning and Sterilization

The metallic tips offer various degree of abrasiveness, ranging from gentle to more aggressive. Finer tips are less abrasive, inducing a gentler exfoliation. **The abrasive surface of tips must ALWAYS be kept clean.**

Metallic tips are made of biocompatible stainless steel material and are reusable. They have to be treated as critical devices meaning that, coming into direct contact with the skin, their disinfection and sterilisation is required.

We recommend having more than one “Crystal free” tips package on hand.



IMPORTANT: *In order to maintain the tip's durability it is recommended to follow the above indicated **CLEANING PROCEDURE:***

1. **BEFORE FIRST USE** and **immediately after each use**, the metal tip should be **cleaned** for few minutes under running water, scrubbing with a fine polymer brush to remove any residues.
2. **Use** a very gentle **disinfectant** with a pH value of no less than 5 and no more than 7 and also containing anticorrosive agents to avoid potential corrosion of the tip. To ensure **MAXIMUM GUARDING** against potential discoloration of the identifying rings of your abrasion tips, please **AVOID any alkaline or acidic products.**
3. **Dry thoroughly** the tips after cleaning.
4. **Autoclave sterilization** is recommended. The tips can withstand steam or dry sterilization.



ATTENTION!

- ✓ *We recommend that you not use the “Crystal Free System” if you are unable to properly clean, disinfect and sterilize metallic tips as per recommendations.*
- ✓ *NEVER immerse tips in any acidic or alkaline solutions to avoid potential tip corrosion.*
- ✓ *ALWAYS keep tips DRY in order to preserve their properties.*
- ✓ *ALWAYS CLEAN TIPS FOLLOWING THE PROCEDURE INDICATED ABOVE.*
- ✓ *ALWAYS use a fine polymer brush to not damage the tips.*
- ✓ *NEVER hit, scratch or damage the tips in order to maintain their abrasive properties.*

NOTE:

It is recommended to replace tips if you observe any reduction in their abrasive properties. For optimal use of your system, **IT IS RECOMMENDED** to replace your tips yearly.

06. Protocol of Crystal Free Procedure

6.1 Procedure Parameters: Metallic Tips

Keeping clients informed and setting reasonable expectations are essential in preventing disappointment, especially with problematic skin (acne scarring, pigmentation problems, scars, etc.).

Clients should be informed that multiple sessions may be required before seeing improvements.

The variable parameters for a successful procedure are:

- Metallic Tip selection: fine, medium, coarse or very coarse.
- Vacuum intensity.
- Number of passes over the skin.

Metallic Tips

The tip will be chosen according to skin sensitivity and coarseness. A fine skin requires a fine tip and a coarse skin requires a coarse tip.

It is very important to maintain the abrasive surface clean.

Vacuum Intensity

The vacuum setting determines the amount of pressure between the skin and the abrasive surface of the metallic tip.

- Low vacuum intensity applies a low abrasive force; it is a conservative procedure.
- High vacuum intensity applies a high abrasive force; it is an aggressive procedure.

A high intensity vacuum setting can cause redness (petechiae). If the redness is too pronounced, reduce the vacuum setting intensity. Redness usually resolves in several hours.



Warning:

- ✓ ***Never use metallic tips around the sensitive eye area. It may cause redness and swelling.***
- ✓ ***Do not apply a high pressure on the handpiece, you can injure the skin.***

Number of Passes

The metallic tip should pass over the skin surface at least two overlapping passes to attain uniform results. Usually, the first pass is vertical and the second pass is horizontal. The speed at which you move the wand is not critical.

6.2 Procedure Schedule

Use basic schedule for the following skin conditions.

- Sun damaged skin.
- Enlarged pores and seborrhea.

Basic procedure schedule should proceed in the following manner for 6 sessions:

- The first 3 sessions should be at 14 day intervals.
- The next 3 sessions should be at 21 day intervals.

Maintenance sessions should be once every 6 weeks. Clients need to comply with a maintenance program to achieve complete results.

6.3 Exfoliation Protocol: Metallic Tips



Important:

- ✓ ***Begin first session using the finest metallic blue tip.***
- ✓ ***Start the first exfoliation procedure with the vacuum adjustment at a low setting.***
- ✓ ***Always perform an intensity test on the client's forearm before proceeding.***

Exfoliation protocol

- Cleanse the skin with a water base or gel cleanser and rinse thoroughly.
- Begin first session using the finest metallic blue tip.
- Start the first exfoliation procedure with the vacuum adjustment at a low setting. **Always perform an intensity test on the client's forearm before proceeding.**
- Keep the skin taut and hand piece at 90 degree angle.
- Always work on small areas one at a time, using a square pattern consisting of 2 horizontal passes followed by 2 vertical (the speed which you move the hand piece is not important). Fewer passes will result in a lighter procedure, more passes, a deeper procedure.
- It is recommended to use short, rapid strokes on sensitive areas
- Always use a magnifying lamp when working, to detect blood specks under the skin and prevent bruising or oozing.
- To reduce redness following an exfoliation procedure, use cold compresses or a soothing lotion.
- Apply a soothing moisturizing mask. Leave on for indicated time, than remove.
- Spray a soothing lotion on the face and apply a protective cream with sunscreen protection.
- **Do not** use a heat mask. We recommend the use of a cold modeling mask to reduce redness.

6.4 Exfoliation Protocol: Diamond Tips & Metallic Tips

Refer to Chapter 5 for **Cleaning instructions** (same procedure to apply).
Proper cleaning of the Diamond tips is essential for maintaining optimum effectiveness.

System set-up

1. Insert the Diamond tip wand into the vacuum tube and connect the tube to the unit.
2. Select the Diamond tip, install filters and screw onto the wand (see Chapter 3 for filter installation).
3. Adjust vacuum pressure.
4. Test the settings on the client's hand or arm. Excessive pressure will cause redness or bleeding. Treatment must be comfortable never painful.

Skin Evaluation: should include a review of your client's skin history and prior experience with skin treatments, a quick examination for any active skin infection(s) or non-healing skin lesion(s) and an overview of your client's expectations.

The entire microdermabrasion treatment last approximately 20 minutes.

General Treatment Information

During Silver Peel treatment procedures **2 types of treatment tips will be used:**

1. **Biocompatible metallic tips** at the beginning and end of the treatment.
2. **Diamond tips** during Phase 2 of treatment procedure to enhance and focus abrasion on specific blemishes.

Selection of Treatment Tips

- ✓ *'Biocompatible metal tips' are selected according to skin sensitivity.*

These tips are used during Phase 1 and 3 of Silver Peel treatments, to quickly perform a general abrasion over the entire area and to even out and smooth skin.

4 metallic tips sizes are available with different abrasion degrees. Silver and Blue tips should be used for the face while Gold and Red for the body.

- ✓ *'Diamond Tips' are selected according to blemish size.*



Diamond Tips:

- Face (1 fine, 1 medium, 1 coarse)
- 1 Eye, 1 Nose
- Body (2 medium, 2 large)

9 sizes available with different degree of coarseness to target specific problems.

Smaller tips are used during Phase 2 of Silver Peel treatments to perform precision abrasion over blemishes.

Select the size and coarseness of the tip. The aggressiveness of the desired treatment will determine grit size while diameter is relative to treatment area size. The Diamond tip heads range in coarseness from fine (D-250 grits) to very coarse (D-100 grits).



Important: Always begin a general abrasion using Biocompatible Metallic Tips and change to Diamond Tips when focusing on blemishes.

Treatment Zones

Divide the face into 3 zones (see next **section 6.5**)

- Using a large biocompatible metallic tip, begin with forehead and proceed downward
- Work on both cheeks and jaw line
- Finish with the neck
- Change to a smaller diamond tip to work on blemishes

Treatment Phases

The treatment is performed in 3 phases

Phase 1 - General abrasion

Phase 2 - Working on specific problem areas and blemishes

Phase 3 - General rapid abrasion to even out complexion

Treatment movements (see next **section 6.5**)

4 specific movements are used during the abrasion process:

- Linear technique for general abrasion,
- Eraser type motion for wrinkles, scars stretch marks,
- Square pattern when working on large areas, such as cheeks afflicted with acne scarring, molted pigmentation or enlarged pores,
- Circular motion when working on isolated pigmentation spots.

General Treatment protocol

Client preparation

- Clean the skin by applying a foaming gel. Using your fingertips work into a lather and rinse thoroughly with warm towels or wet gauze.
- Choose the appropriate abrasion tip.
- **Test the intensity on the client forearm.**

Treatment

- Depending on skin type and reaction to treatment perform between 3 to 4 passes using a large biocompatible metallic tip.
- Use smaller diamond Tips to work on individual blemishes.
- Remove any dead cells and debris with a gentle soothing lotion.
- If needed, proceed with a gentle extraction of blackheads and comedos.
- Use the High Frequency to disinfect the area.
- Apply a treatment product suitable to your client's needs.
- Apply a treatment mask according to skin problem and skin reaction.
- Apply a moisturizer selected according to skin type.
- Apply a sun screen SPF 15-30.

Specific treatment protocols

Wrinkle treatment

- Depending on skin type and reaction to treatment perform between 3 to 4 passes using a large biocompatible metallic tip.
- Change to smaller diamond Tip D-250, and with linear and eraser movements work on individual wrinkles, while holding skin taught between 2 fingers. Take time to frequently reassess abrasion depth with a magnifying lamp.
- Remove any dead cells and debris with a gentle soothing lotion.
- Apply a rejuvenating treatment product suitable to your client's needs.
- Apply a rejuvenating treatment mask according to skin problem and skin reaction.
- Apply a moisturizer selected according to skin type.
- Apply a sun screen SPF 15-30.

Skin blemishes treatment (*black heads, comedos enlarged pores*)

- Depending on skin type and reaction to treatment perform between 3 to 4 passes using a large biocompatible metallic tip,
- Change to a medium diamond tip (D-250 for fine skin, D-200 for medium and D-100 for thicker skin) to work on individual blemishes.
- Use a square pattern movement on enlarged pores or areas affected with blackheads and comedos
- Use a gentle soothing lotion to remove any dead cells and debris
- If needed, proceed with a gentle extractions of blackheads and comedos
- Use the High Frequency to disinfect the area
- Apply a purifying treatment product suitable to your client's needs.
- Apply a purifying treatment mask suitable for your client's skin.
- Apply an oil free moisturizer selected according to skin type.
- Apply a sun screen SPF 15-30

Treatment for uneven pigmentation

- Depending on skin type and reaction to treatment perform between 3 to 4 passes using a large biocompatible metallic tip,
- Change to a medium diamond tip (D-250 for fine skin, D-200 for medium and D-100 for thicker skin) to work on individual pigmentation spots
- Use a gentle soothing lotion to remove any dead cells and debris
- If needed, proceed with a gentle extractions of blackheads and comedos
- Use the High Frequency to disinfect the area
- Apply a whitening treatment product suitable for your client's skin,
- Apply a whitening treatment mask suitable for your client's skin.
- Apply a moisturizer selected according to skin type.
- Apply a sun screen SPF 15-30

Treatment for superficial scars (*face or chest*)

- Depending on skin type and reaction to treatment perform between 3 to 4 passes using a large biocompatible metallic tip,
- Change to smaller diamond Tip D-200, and with linear and eraser movements work on individual wrinkles, while holding skin taught between 2 fingers. Take time to frequently reassess abrasion depth with a magnifying lamp.
- Use a gentle soothing lotion to remove any dead cells and debris
- Apply a treatment product suitable for stretch marks or scars
- Apply a treatment mask according to skin problem and skin reaction
- Apply a moisturizer selected according to skin type.
- Apply a sun screen SPF 15-30

Treatment for stretch marks or body scars

- Depending on skin type and reaction to treatment perform between 4 to 8 passes using a large biocompatible red tip,

Use larger diamond Tips (D-220 or D-180) to work on individual stretch marks and scars. Use the largest (D-180 or D-100) for deep and large stretch marks.

- Using linear and eraser movements, hold the skin taught between two fingers taking care to frequently reassess the depth of abrasion (skin must turn red).
- Use a gentle soothing lotion to remove any dead cells and debris
- Apply treatment product suitable for stretch marks or scars.
- Apply a sun screen SPF 15-30, to exposed skin.

6.5 Procedure Chart

Divide the face into 3 Zones

- **Zone 1: Forehead** (below the hairline and above the eyebrows).
- **Zone 2: Mid face area** (nose, cheeks, jaw, upper and lower lip, chin).
- **Zone 3: Neck and neckline.**

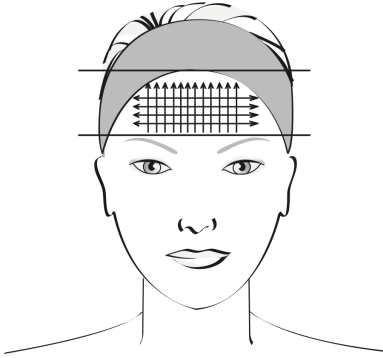

Zone 1: Forehead

- Be conservative during the first procedure using a magnifying lamp to reassess the abrasion. Use a **fine or medium tip** and **vacuum intensity setting at lowest value**.
- Start by proceeding from the brows to the hairline vertically. Go over area repeatedly to desired depth of exfoliation. Repeat the pattern horizontally.

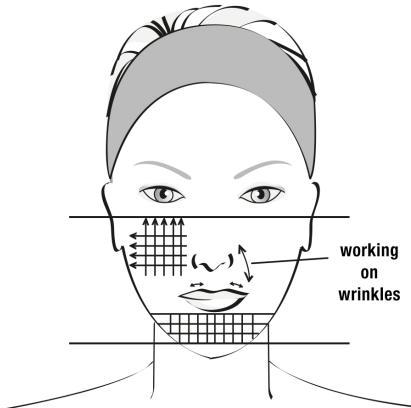

Zone 2: Mid-face area

Use a fine or medium tip and vacuum intensity setting at lowest value.

Take additional steps to keep the skin taut and avoid areas around the eye.

- Begin on the side of the face with vertical passes and cross with horizontal passes. Go over areas repeatedly to achieve desired depth of exfoliation.
- Move down on the nose following the contours, and around the creases.
- Work the upper lip area moving horizontally from the corner of the mouth over to encompass the smile lines. Make sure the skin is kept taut.
- Then pass to the chin and lower jaw areas with vertical and horizontal passes.
- **Never pass on the lip's border and colored part.**
- For horizontal wrinkles use horizontal passes, for vertical, use vertical passes.

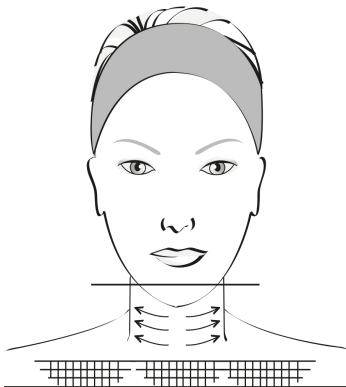

Zone 3: Neck and neckline

Use the **fine or medium tip with reduced vacuum intensity** when working on the neck to avoid streaking. Always make sure the skin is held taut.

- Most clients require only horizontal passes on the neck area. Passes are performed from center outward.
- The Décolleté' will require vertical and horizontal passes using the fine or medium tip with lower vacuum setting similar to the neck.

After fully exfoliating the face & neck area, return to areas requiring more attention such as pigmentation, wrinkles or scars.

After procedure:

- Rinse treated area with soothing lotion and cool compresses.
- Apply appropriate calming or cooling mask, leave on for 5-10 min.
- Remove product with cool towel.
- Apply moisturizer and sun block.

6.6 Potential Side Effects

During the 3rd or the 4th day following a session, skin may desquamate if the intensity used during the procedure was too high.

Swelling and redness:

- May be due to aggressive or low pH acid products used after the procedure.
- Low pH products containing Retinol-A, AHAs, enzymes or essential oils may also cause skin irritation when used after skin abrasion. Skin will therefore be over treated and may react causing swelling, heating or redness.
- Following over aggressive procedures, some skins may also show slight swelling. This is not a problem. Apply calming and hydrating products.
- Petechial rash may appear during or after the procedure. This usually indicates that the vacuum setting is too strong. Working with low intensity on mature skin will avoid the problem.

Allergic skin reaction:

- An allergic reaction to a cosmetic product will cause an intense heat sensation, intense redness or itching during product application. You must remove the product immediately and use a cooling mask.

Pigmentation problems:

- Be extra careful with skin that is prone to hyper pigmentation. Avoid the sun and tanning beds and use sun block at all times (SPF 15 or SPF 30).



Very Important:

- ✓ *During consultation, we recommend giving to each client a “Client Instructions Sheet”.*
- ✓ *It is recommended to perform consultation and exfoliation sessions at 2 to 3 weeks intervals.*
- ✓ *Most skin reactions can be avoided by providing the “Client Instructions Sheet”, prior to first procedure.*

07 . Consent Form

Microdermabrasion is a widely used procedure performed by licensed estheticians, involving the exfoliation of the outer layers of the skin. This is accomplished by skin rubbing with a metallic piece made of surgical grade stainless steel. The procedure is gentle and respects the integrity of the skin, with literally no recovery time for most people, though there are a few areas of the face where the procedure may feel slightly uncomfortable. Microdermabrasion has been successful in temporarily improving the appearance of small scars, large pores, pigmented spots, fine lines, wrinkles and comedones. This may take several sessions (average six) the number of which varies with each individual. _____

Even is the stainless steel tip is not allergenic, possibility of allergic reaction might happen. To test this, a patch test will be always performed prior to microdermabrasion. _____

After exfoliation, some reactions as swelling, redness or petechial spots (red to purple skin spots) might appear, due to individual skin reactions and sensibility of each person. _____

During cold sore, herpes simplex, inflammatory or acne eruptions, it is necessary to discontinue sessions to avoid spreading the condition. The procedure should be deferred until the skin is perfectly healed. _____

Because the skin, after microdermabrasion, has no natural protection, it is necessary to use neutral pH moisturizers and to wear a protective sunscreen no less than SPF 15 but no more than SPF 35. Failure to wear sunscreen can result in sunburn on your face, and skin damage could occur. _____

I do not present any of Contraindications:

(Yes) _____ (No) _____ (Check one)

If yes, Microdermabrasion procedures cannot be performed _____

While many satisfying results are achieved after six (6) session series, there is no guarantee that the desired effects will be achieved within that delay. Your own body response is a major factor in the result process. _____

I have read the preceding explanations and understand the potential risks and benefits of microdermabrasion. I received a copy of the "Client Instructions" sheet and agree to follow them and to protect my skin against the sun at all time.

Client Name : _____ Signature : _____

Telephone Number : _____ Date : _____

Witness Name: _____ Signature: _____

08. Client Instructions Sheet

Prior to peel

- Discontinue use of: retinoids (Retin-A, Renova), AHAs (glycolic or other acids) or any other chemical peels at least one week prior to peel.
- Postpone procedure in case of active herpes (cold sore) outbreak or if you plan exposure to strong sunlight (such as sailing, skiing).

Immediately after peel

Moisturizer and sunscreen will be applied before leaving facility.

- Your skin will feel like a mild wind burn or sunburn. Maintain hydration, both topically and internally (drink plenty of water).
- Moisturize and reapply sunscreen several times throughout the day, as needed.
- **Avoid** direct sunlight as you now have fresh, newly exposed skin.
- **Avoid** whirlpool or swimming in a chlorinated pool the day of the exfoliation.
- **Avoid** waxing treated areas for two (2) weeks after procedure.

After peel

- Maintain hydration of skin and increase fluid intake.
- Continue to use sunscreen at least SPF 15 up to SPF 35. *(The use of a sunscreen above SPF35 is not recommended as it can induce irritation following skin exfoliation).* Be extra careful if skin is prone to hyperpigmentation and use sunscreens at all times.
- Exposure to UV rays **must be avoided** during 7days after exfoliation.
- **Avoid** retinoids, glycolic acids or any chemical peels and for three (3) weeks following procedure.

09. Important

User responsibility

This system makes no medical claims. This procedure is not used in any mean of treating any medical pathological condition. The system is intended and should be used by licensed estheticians for esthetic purposes only.

Terms microdermabrasion, abrasion, exfoliation or peeling terms describe the same procedure: the esthetic exfoliation.

The masculine generic refers to both the masculine and feminine genders and is used for conciseness purposes only.

- If you have questions regarding the operation of this system, call Silhouet-Tone or your local distributor.
- Silhouet-Tone is not responsible for damage or accidents caused by the incorrect or unprofessional usage of the system.

Silver Peel system includes:

- 416003 | 3 internal filters for « Crystal Free » metallin tips hand piece
- 416541 | 1 pack of 20 filters for diamond tip hand piece
- 420975 | 1 instructions manual
- 416681 | 1 kit diamond tip*
- « Crystal Free » kit includes :
 - 416690 | 1 hand piece
 - 416683** | 1 tip fine abrasion (blue color)
 - 416685** | 1 tip medium abrasion (silver color)
 - 416687** | 1 tip coarse abrasion (gold color)
 - 416689** | 1 tip very coarse abrasion (red color)
 - 416004 | 1 vacuum tube
 - “Crystal Free” Instructions Manual

*Diamond tip kit can be ordered “as is” only

**Metallic tips scan be ordered separately.

10. Warranty

Limited warranty

Please refer to Silhouet-Tone's Warranty Policy.

The System is designed to perform as described in this manual when operated, maintained, and repaired in accordance to the instructions provided. Components that are broken, missing, plainly worn, distorted or damaged should be replaced before further use. The user of the System shall have the sole responsibility for any malfunction, which results from improper use, faulty maintenance, improper repairs, damage, or alteration by anyone other than Silhouet-Tone or an authorized Silhouet-Tone representative.

REFER SERVICING TO QUALIFIED PERSONNEL ONLY.

11 . Specifications

CSA Approved	
Universal Power Supply :	120/230 VAC, 60/50Hz, 0.5 A
Fuse Type :	1A SB (120/230 VAC)
Maximum Intermittent Vacuum Level:	- 0,5 bar
Sound Level at Maximum Free Flow:	65 dB - C Scale
Unit Dimensions:	Width : 12.0 in (300 mm) Height : 6.0 in (150 mm) Depth : 12.0 in (300 mm)
Unit Weight:	8 lbs (3.8 kg)
Construction:	Epoxy Coated Metal Housing Accessory Tray Injection Molded Face Low Noise from Sound Damping Components
Electronics:	Accurate Microprocessor Controlled Drive System
Safety Filter :	Long-Life Replaceable Cartridge and Filter
Ambient Operating Temperature :	+10 to + 35 °C
Ambient Operating Humidity:	30 to 60 % RH

SILHOUET-TONE RESERVES THE RIGHT TO CHANGE THESE SPECIFICATIONS WITHOUT NOTICE.

All rights reserved. No part of this work covered by the copyright hereon may be reproduced or used in any form or by any means— graphic, electronic, or mechanical, including photocopying, recording, taping, or information storage and retrieval systems— without permission of the company.
© Silhouet-Tone Corporation 2016