

HIGH FREQUENCY

(please consult the MULTIPLE BEAUTY INSTRUMENT)

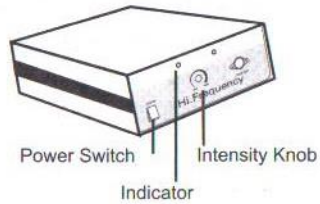

(hardware)

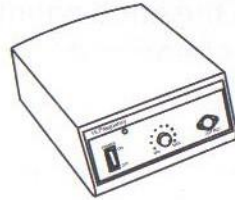

(plastic)

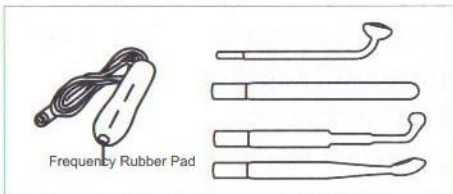

Basic equipment

IONOSMITER(GALVANIC)

(please consult the MULTIPLE BEAUTY INSTRUMENT)

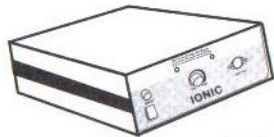

(hardware)

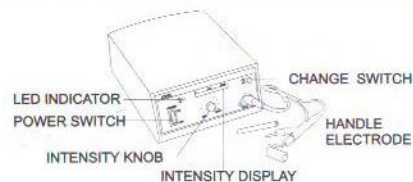

(plastic)

MASSAGE BRUSH

Function:

The purpose of the Massage Brush is to slough off the dead cells and remove any dirt and grime that clings the surface of the skin. Before any peeling is done the skin should be cleaned with either viscose sponges or cotton pads. And the face is vaporized or steamed with warm, moist towels soften the dead surface cells so that they can be more easily removed. And the turning brushes also the massage valid.

Operating Guidance:

- 1) Select an appropriate brush and insert into the Brush Handle, It will be locked in place as hear click sound.
- 2) Turn switch ON then set speed according to clients skin condition. Usually slow peeling speed can be used on dry and sensitive and faster speed on skin that is coarse and thick.
- 3) Turn handle switch, the brush turn clockwise then anti-clockwise.
- 4) The peeling, start on the neck, thug, chin, cheeks, upper lips, nose and forehead.
- 5) The way to change brush: Turn switch OFF first, then use a slight force to pull off the brush and insert another brush.
- 6) Types of brushes and usage:
 - a) Bigger wool brush: for cheek, chin and forehead.
 - b) Small wool brush: for eyelids, lips and nose.
 - c) Sponge brush: for sensitive skin.
 - d) Plaster brush: for dead surface or coarse skin.

Caution:

- 1) Skin with broken capillaries, brushes may used very lightly over this area, And the severe broken capillaries peeling had to be avoided.
- 2) The brush should be vertical with skin .
- 3) Avoid setting Hair into brush.
- 4) Following each treatment the brush should be thoroughly cleaned by washing with mild detergent and warm water, then place in a small bowl of alcohol for 20 minutes of sterilized. When not use, the cleaned brushes can be stored store in the sterilizer cabinet.
- 5) The brush should always be moist with water to soften the bristles.
- 6) A tissue is held over the brush after moisturizing and the machine is turned on at a slow speed for few seconds to remove excess moisture.



(hardware)

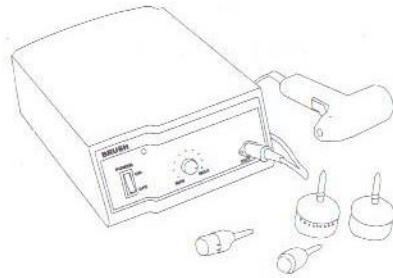

(plastic)

BREAK DOWN EXAMINATION & REMOVING

Item	general malfunction	examination	method of handling
MULTIPLE BEAUTY INSTRUMENT	failure to work	plug is /not connected	insert plug into outlet again
GALVANIC		no fuse available	replace new one
VACUUM & SPRAY		plug is/not connected and moved	insert plug
HIGH FREQUENCY			
BRUSH			

Attention: If the machine don't be repaired by our company or retailer's technicians and is disassembled or assembled without permission, we aren't responsible for the consequences resulted.